

HSF

NOTES:
 Current Rating: 1.0AMP
 Contact Resistance: 10mΩ Max
 Withstand Voltage: 1000V AC/DC
 Mechanical Life: Min 100 cycles
 Connecting Pin: ∅0.50mm
 Operation Temperature: -40°C to +105°C

Contact Material: Brass CuZn36Pb3(C36000)
 Contact plating: Au over Ni
 Insulator Material: PPS+30%G.F UL94V-0
 06P~18P Insulators without center bar
 20P~28P Insulators with center one bar

Ordering Information

3560-301 XX M XX 102 X 1

Row of Pitch
l=7.62mm

No. of Pin
See tab

Contact Plating
G0=Gold Flash
G3=10u"Gold
G4=15u"Gold
G5=30u"Gold

Packing
T=Tube
R=Tape&Reel

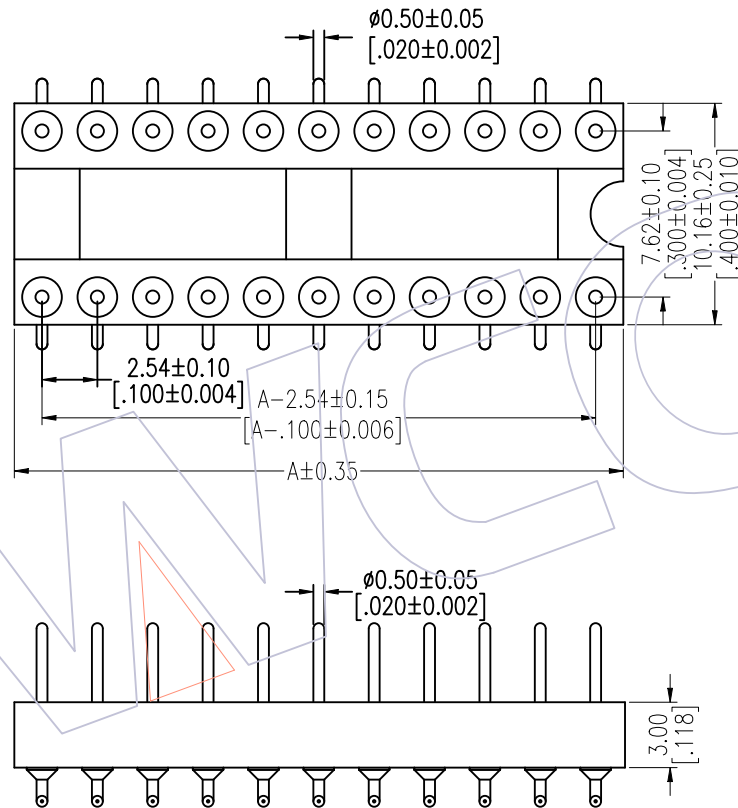

Recommended P.C.B Layout(Top Side)
 (PCB BOARD TOLERANCE±0.05)

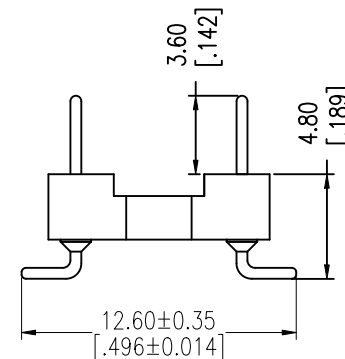
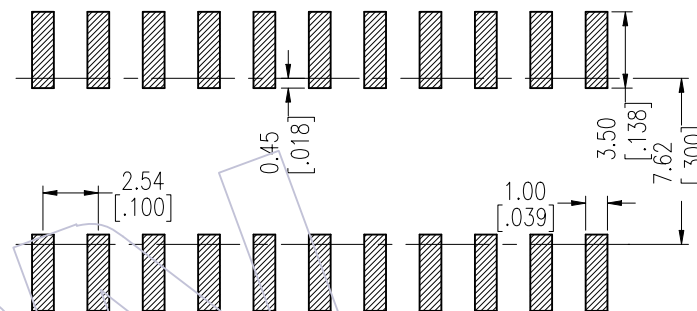

Dimensional & Ordering Information

NO. of Poles	Part No.	Dim
		A
06	3560-30106MXX102X1	7.62
08	3560-30108MXX102X1	10.16
10	3560-30110MXX102X1	12.70
12	3560-30112MXX102X1	15.24
14	3560-30114MXX102X1	17.78
16	3560-30116MXX102X1	20.32
18	3560-30118MXX102X1	22.86
20	3560-30120MXX102X1	25.40
22	3560-30122MXX102X1	27.94
24	3560-30124MXX102X1	30.48
28	3560-30128MXX102X1	35.56

REV	DATE	MODIFICATION DESCRIPTION	CHANGE	OPERATION	DRAW	DATE	SCALE	FIT	PART NO.
A0	2012/11/05	NEW	-----	x.x ±0.40	JYHuang	2012/11/05	UNIT	mm	SEE TAB
				x.xx ±0.25	CHECK	DATE	SIZE	A4	TITLE:
				x.xxx ±0.15	APPROVE	DATE	SHEET	1/1	2.54mm MACHINED ADAPTER CONNECTOR
				Angle ± 3'			PROJ.	Customer NO.	SMT H=3.0 L=10.20 Row of Pitch 7.62
				DIM	TOL				

WCON

Http: www.wcon.com

WCON-Dongguan
 Tel: +86 769 85358920
 Fax: +86 769 85358915
 E-mail: sales@wcon.com

WCON-Kunshan
 Tel: +86 512 57468408
 Fax: +86 512 57468468
 E-mail: salesks@wcon.com